

# Server Slide Collection

*Slides for Electronic Enclosure Applications*

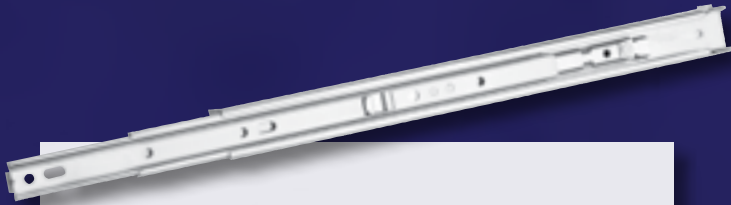

*Accuride's server slide collection offers a selection of solutions for chassis ranging in size from 1U to 8U. These products include features specifically designed to address the unique requirements of enclosures.*

## **Narrow Side Space**

A critical element in rack applications, this collection offers narrow cross sections to maximize chassis space, while still providing solid load capacities.

## **Over Travel**

Access to wiring and connections at the back of chassis is important. These slides provide two inches of over travel, affording plenty of access to components.

## **Adjustable Mounting Brackets**

Included in standard packaging, the mounting brackets for these products are engineered to fit the greatest range of enclosure depths, rail configurations, and hole styles.

## **Lock-Out**

All of the slides feature a mechanism to lock chassis in the extended position. This makes for safe and secure access when performing maintenance or service.

## **Disconnect Method**

These slides all include a disconnect method, which allows the end user to remove the chassis from the enclosure.



**Accuride**<sup>®</sup>

# Server Slide Collection



## Model 2807

1U-2U Chassis

This product is an economical, light-duty friction slide. The most outstanding feature is the exceptionally small profile, which is just over 1-inch tall, making it a good choice for lightweight 1U applications.

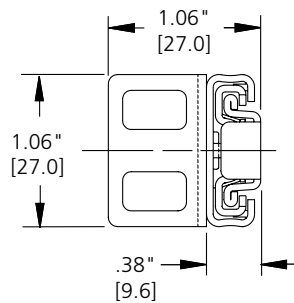

- Up to 100-lb. load rating
- .38" side space
- 2" over travel
- Latch disconnect
- Lock-out
- Enhanced friction movement
- Fixed front bracket
- Attached rear bracket provides 2" of adjustment
- Brackets compatible with 5/8" and 1/2" pitch patterns
- Slotted holes on brackets adapt to round, square, or tapped holes.
- Even lengths 10"-30"
- Clear zinc finish



## Model 2907

1U-4U Chassis

This is a full ball-bearing slide that provides smooth movement for medium-duty chassis applications. It comes with a removable locator pin that supports and holds the slide in place during installation. The brackets offer a little more length adjustment than the 2807 and include an embossed hole that self-aligns to racks with square mounting holes.

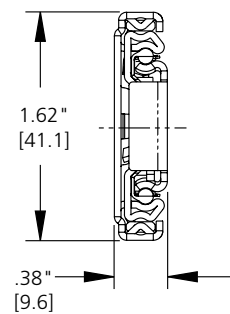

- Up to 115-lb. load rating
- .38" side space
- 2" over travel
- Lever disconnect
- Lock-out
- Locator pin holds slide in place during installation.
- Adjustable mounting brackets provide 2" of adjustment and accommodate round, square, or tapped holes.
- Even lengths 12"-30"
- Clear zinc finish

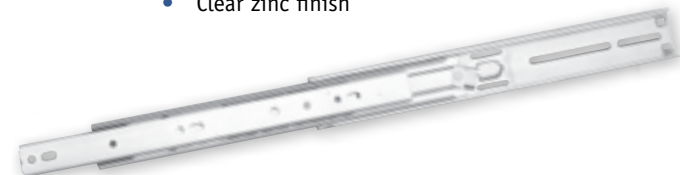

Model 2907WB offers reversible brackets that fit all pitch patterns, allowing for more options when positioning chassis.



## Model 2907WB

1U-4U Chassis

This ball bearing slide provides a single-point solution for the white box enclosures category. It offers standard or tool-less pin mounting of the chassis member, and a unique thumbscrew fastener that adapts to round, square, or tapped holes.

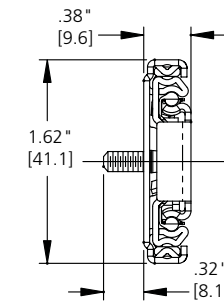

- 120-lb. load rating
- .38" side space
- 2" over travel
- Lever disconnect
- Lock-out
- Reversible brackets fit both 5/8" and 1/2" pitch patterns, and dual 5/8" patterns.
- Brackets adjust to fit a full range of cabinet depths and chassis setback positions.
- Rear bracket offers an adjustment range of up to 9".
- Slide-to-chassis hole patterns fit multiple chassis mounting configurations.
- Even lengths 22"-26"
- Clear zinc finish

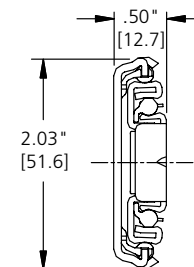
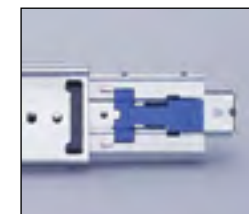

## Model 3507

4U-8U Chassis

Model 3507 has a beefy load capacity of a constant 200 pounds for all slide lengths offered—with a mere 1/2-inch cross section. This is the slide choice for chassis from 4U to 8U in height. This product features One-Motion Insertion, which eases the insertion of large, heavy chassis into enclosures.

- 200-lb. load rating
- .50" side space
- 2" over travel
- Lock-out
- Pinch-free latch disconnect located at the front of the slide.
- One-Motion Insertion simplifies reinsertion and installation
- Guide pins provide stability for cable management attachment directly to slides.
- Embossed holes on brackets adapt to round, square, or tapped rack holes
- Rear bracket provides two inches of adjustment.
- Even lengths 16"-30"
- Clear zinc finish

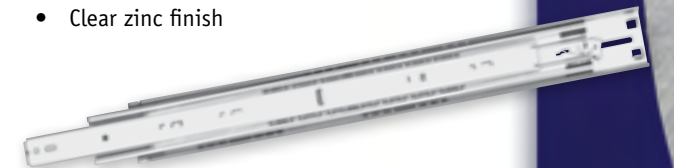

## Cable Carriers

Accuride offers two standard cable carriers, which provide the means to collect wires into a neat bundle. This prevents sagging or snagging at the back of the chassis. These products are compatible with the entire server slide collection.

CC9



CC11

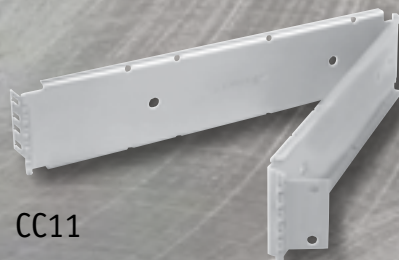

### CC9

*For use with round cables*

- CC9-1: Standard 23" long when fully extended
- CC9-2: Manufactured to order, 29" long when fully extended
- Quick disconnect chassis fasteners
- Designed for chassis 2U and larger
- Clear zinc finish

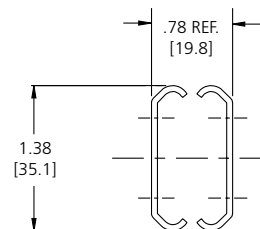

### CC11

*For use with ribbon cable*

- 28.24" long when fully extended
- Wide arm
- Use customer-approved cable ties
- Clear zinc finish

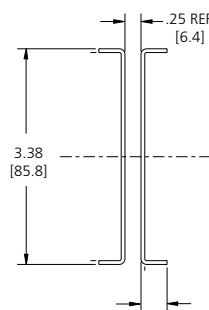

## Custom Requirements

For special order or large volume projects, talk to your Accuride rep about the special features such as customized brackets and cable carriers, tool-less solutions, and enhanced performance features.

*Authorized Distributor*

# Accuride

12311 Shoemaker Avenue  
Santa Fe Springs, CA 90670  
(562) 903-0200  
(562) 903-0208 Fax  
[www.accuride.com](http://www.accuride.com)

Follow us

